

MALTON GRAMMAR SCHOOL.

North North Riding County Council.
Education Committee.

John L. Conrath, L.L.B., Assistant
Education Officer, County Hall,
Northallerton.

Luffley

Contractors Copy

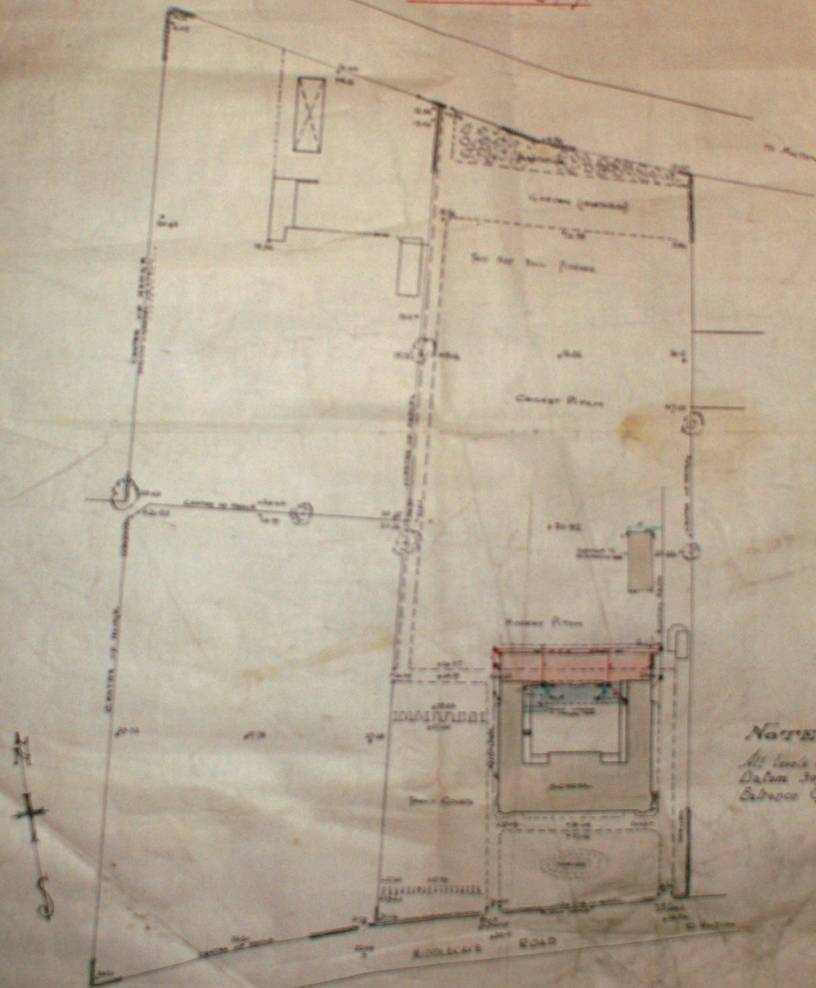

NOTES

All lines are being to show
Detail of the Building
Entrance Gate

BLOCK PLAN

Scale Feet (vertical to horizontal)